

NC 550S - PLYWOOD

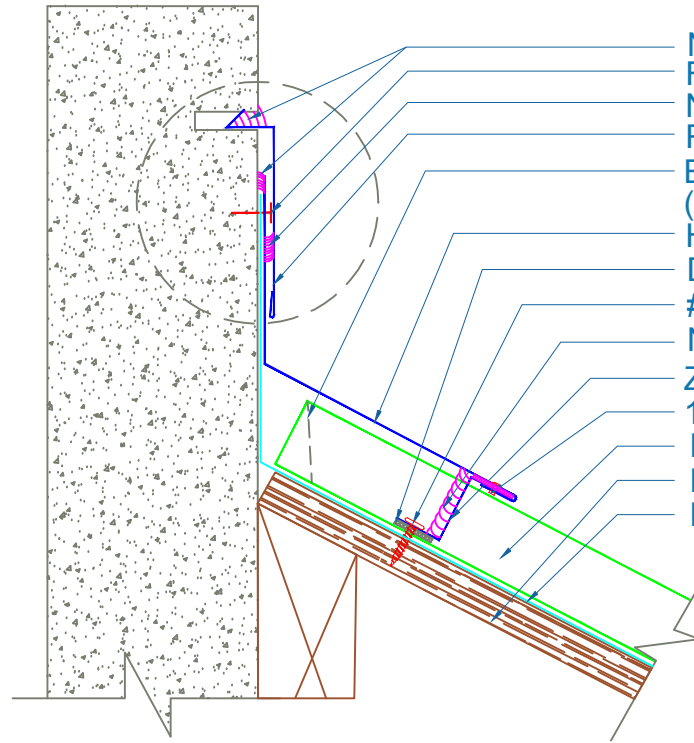

NEW CASTLE APPROVED TUBE SEALANT
 FASTENERS (BY OTHERS)
 NEW CASTLE APPROVED TUBE SEALANT
 REGLET FLASHING
 BOX END OF PANEL
 (SEE ZEE CLOSURE OPTIONS DETAIL)
 HEADWALL FLASHING
 D.B. TAPE SEALANT
 #10 - 13 x 1" PHW (5 PER PANEL)
 NEW CASTLE APPROVED TUBE SEALANT
 Z-CLOSURE FLASHING
 1/8" - #43 POP RIVET (18" o.c.)
 NC 550S PANEL
 PLYWOOD SUBSTRATE (1/2" MIN.)
 NEW CASTLE UNDERLAYMENT

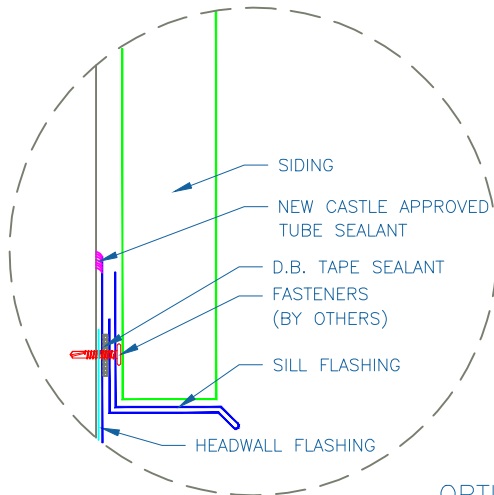

OPTION 1

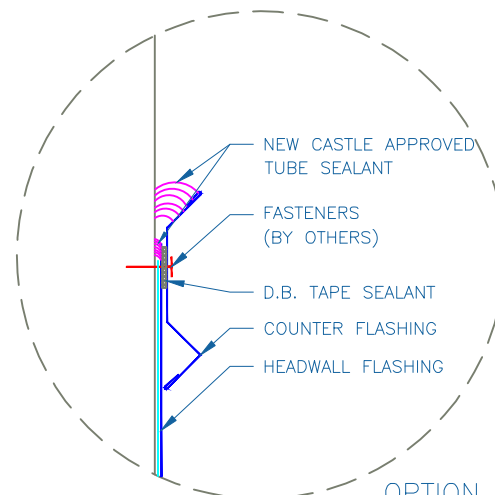

OPTION 2

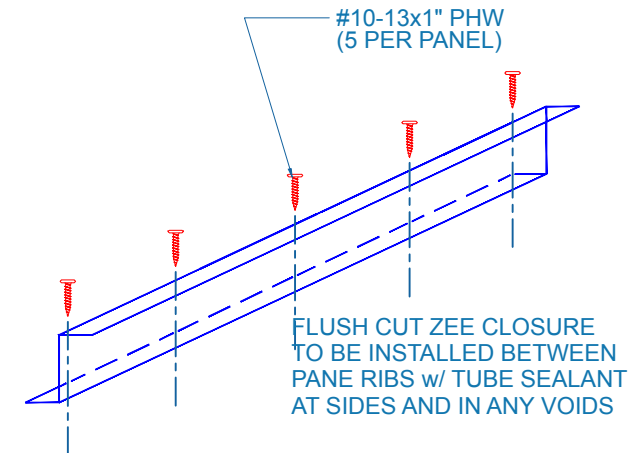

SUBJECT TO CHANGE WITHOUT NOTICE

HEADWALL

SCALE: 3" = 1'-0"

NEW CASTLE
METAL